

# TALL VECTOR™ 50 DIRECT VENT LINEAR GAS APPLIANCE



## Specifications: Single-sided

Model	BTU	Width		Height		Depth		Viewing Area
		Actual	Framing	Actual	Framing	Actual	Framing	
TLV50N	36,000	65 5/16	65 13/16	47 15/16	48 3/16	19 7/8	20 1/8	52 9/16 X 26 13/16
TLV50LN								
TLV50P	31,500	65 5/16	65 13/16	47 15/16	48 3/16	19 7/8	20 1/8	
TLV50LP								

## Dimensions: Single-sided

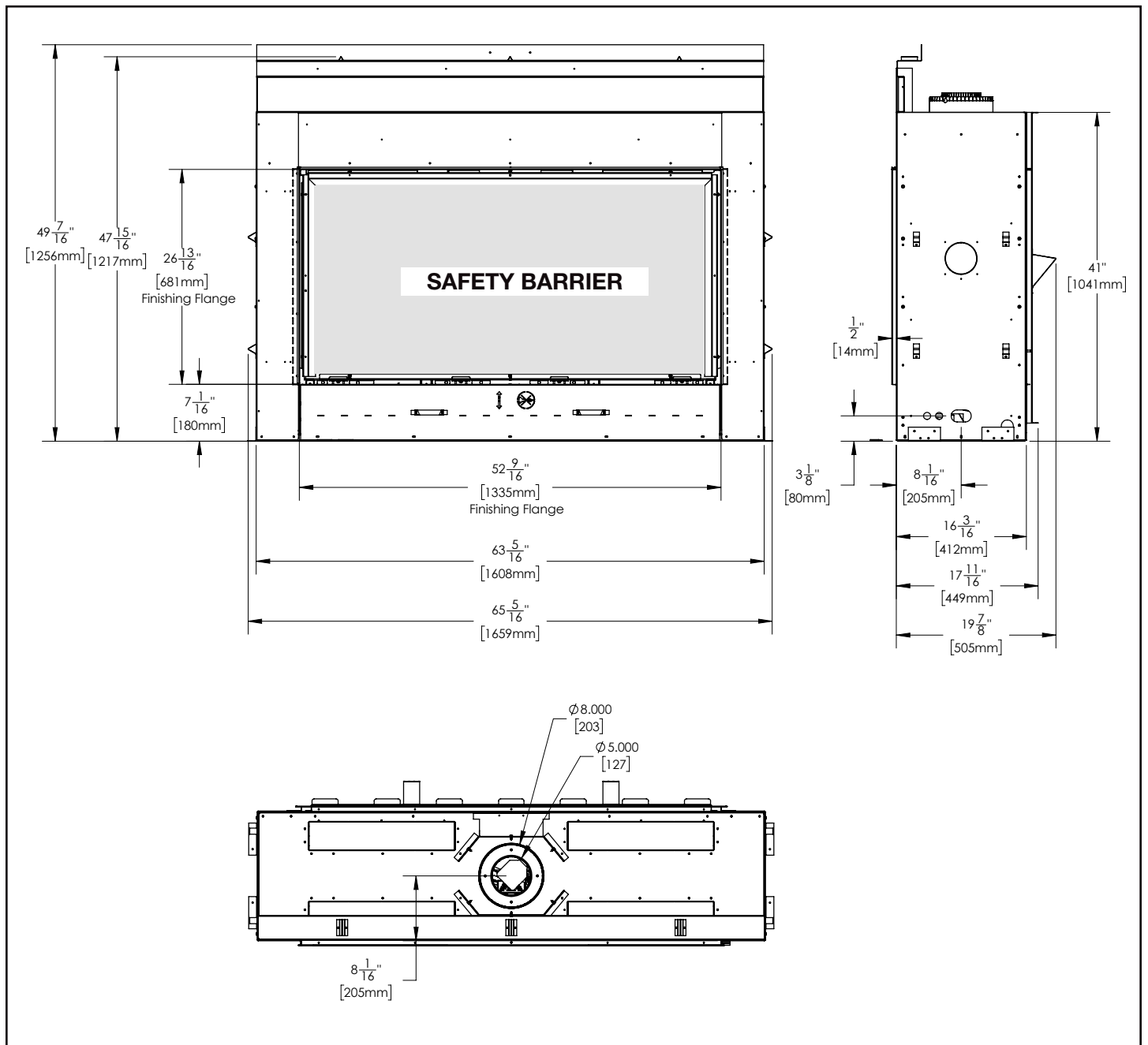

Product information provided is not complete and is subject to change without notice. Please consult the installation manual for the most up to date installation information.

W415-4142 / C-0 / 04.09.24

# TALL VECTOR™ 50 DIRECT VENT LINEAR GAS APPLIANCE



## Specifications: See-through

Model	BTU	Width		Height		Depth		Viewing Area
		Actual	Framing	Actual	Framing	Actual	Framing	
TLV50N2	36,000	65 5/16	65 13/16	47 15/16	48 3/16	16 3/16	16 3/16	52 9/16 X 26 13/16
TLV50LN2								
TLV50P2	31,500	65 5/16	65 13/16	47 15/16	48 3/16	16 3/16	16 3/16	
TLV50LP2								

## Dimensions: See-through

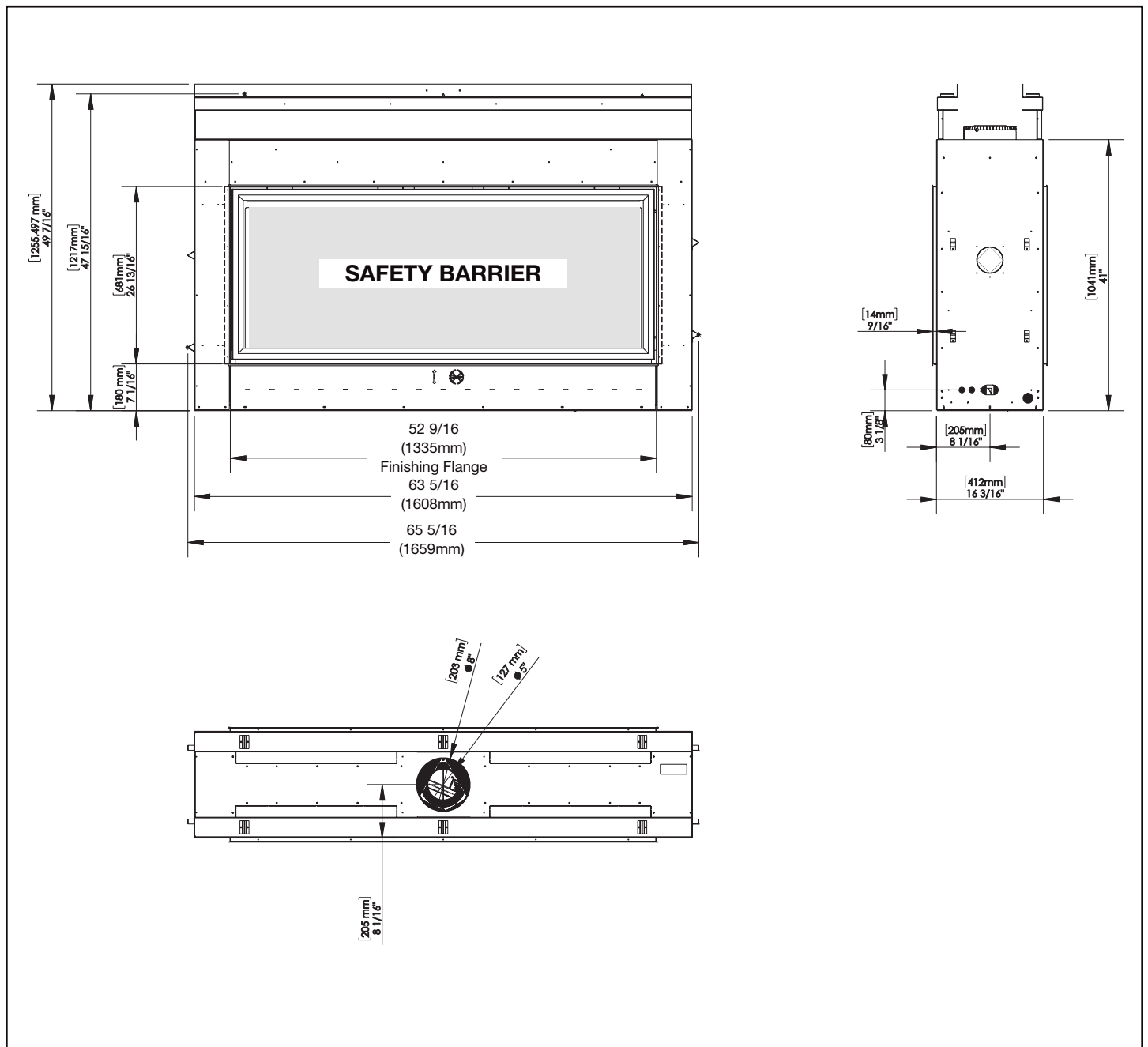

Product information provided is not complete and is subject to change without notice. Please consult the installation manual for the most up to date installation information.

W415-4142 / C-0 / 04.09.24

# TALL VECTOR™ 50 DIRECT VENT LINEAR GAS APPLIANCE



Product information provided is not complete and is subject to change without notice. Please consult the installation manual for the most up to date installation information.

## Finish Framing

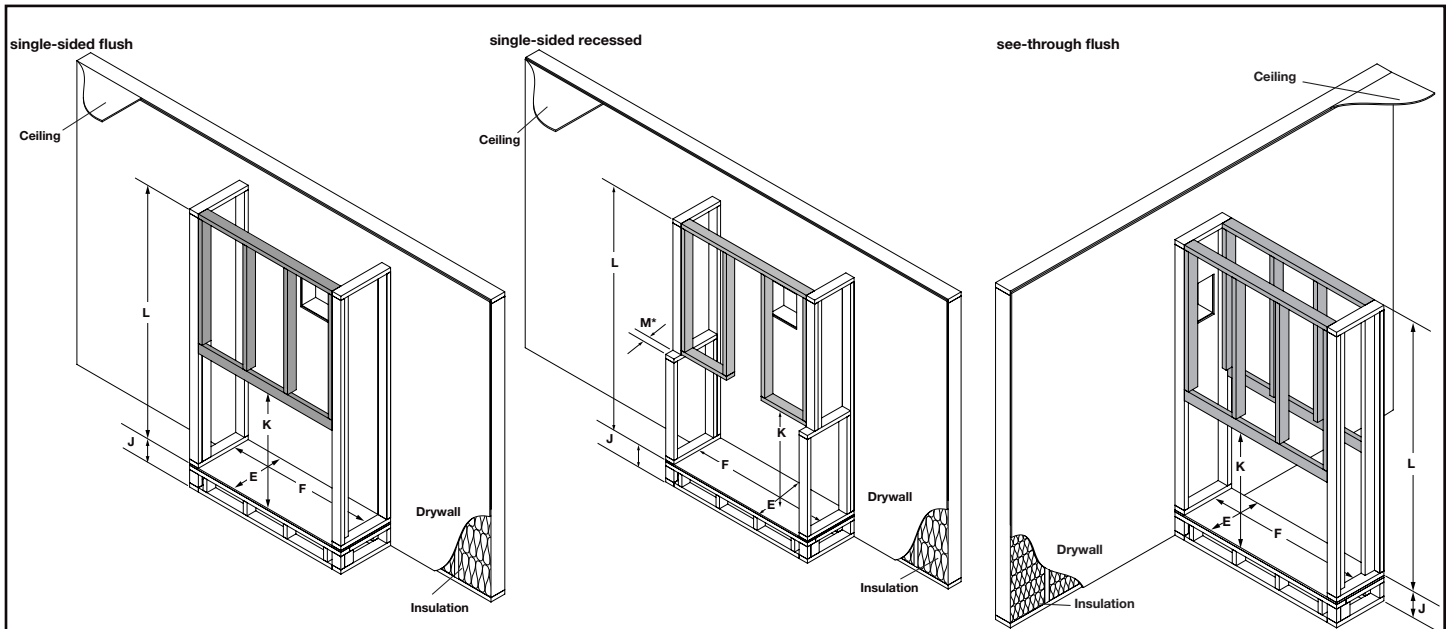

Ref.	TLV50 / TLV50L single-sided
K	48 3/16" (1224mm)
E	20 1/8" (511mm)
F	65 13/16" (1672mm)
J	Optional - Appliance does not need to be elevated above floor.
L	73" (1854mm)
M*	3" (76mm)

Ref.	TLV50_2 / TLV50L2 see-through
K	48 3/16" (1224mm)
E	16 3/16" (411mm)
F	65 13/16" (1672mm)
J	Optional - Appliance does not need to be elevated above floor.
L	73" (1854mm)

\*Can only be increased to 4" max by building a protrusion.

### note:

The TLV series requires a minimum enclosure/ceiling height, as illustrated (dimension L), measured from the bottom of the appliance. For temperature requirements, this area must be left unobstructed. Some venting configurations that require more vertical rise will require a larger enclosure to provide minimum vertical clearance between vent pipes and combustibles.

## Combustible Mantel Clearances

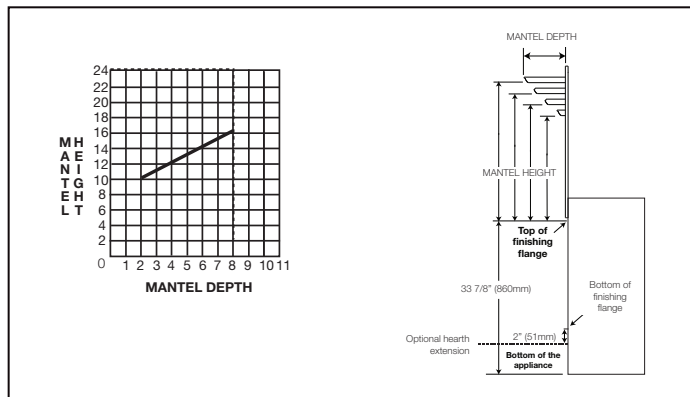

## Appliance Location

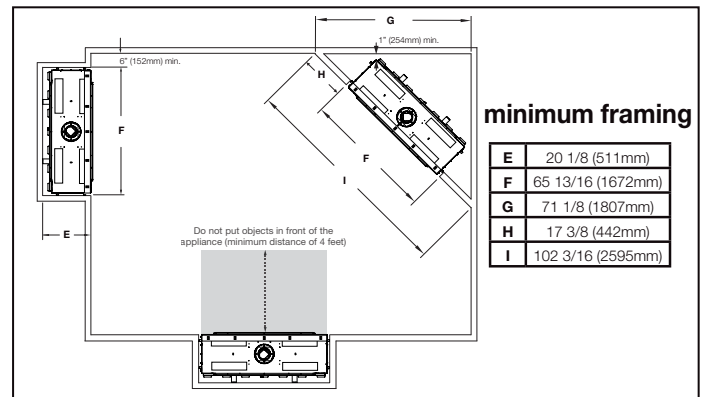

W415-4142 / C-0 / 04.09.24

# TALL VECTOR™ 62 DIRECT VENT LINEAR GAS APPLIANCE



## Specifications: Single-sided

Model	BTU	Width		Height		Depth		Viewing Area
		Actual	Framing	Actual	Framing	Actual	Framing	
TLV62N	44,000	77 5/16	77 13/16	47 15/16	48 3/16	19 7/8	20 1/8	64 9/16 X 26 13/16
TLV62LN								
TLV62P	38,000	77 5/16	77 13/16	47 15/16	48 3/16	19 7/8	20 1/8	
TLV62LP								

## Dimensions: Single-sided

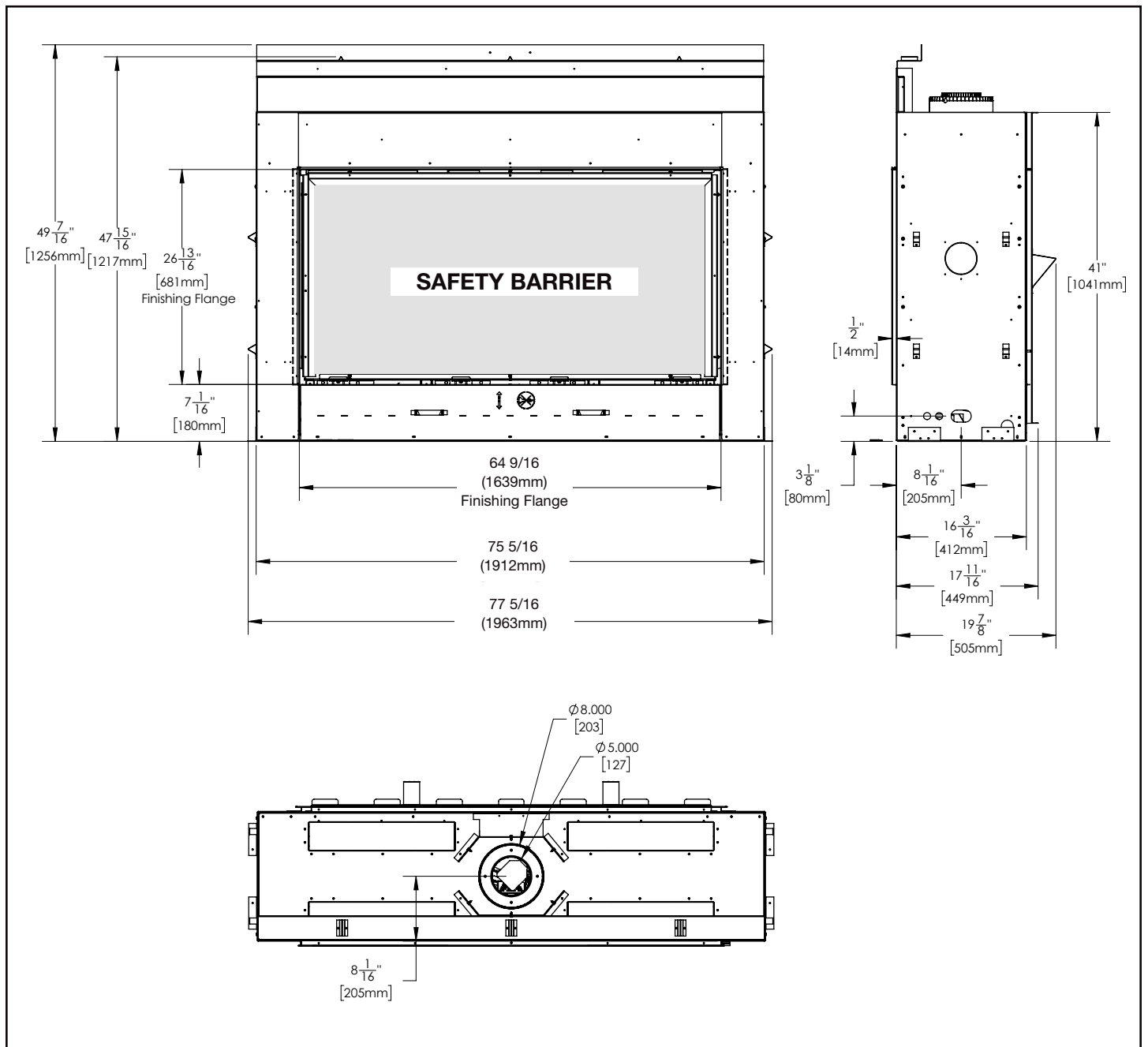

Product information provided is not complete and is subject to change without notice. Please consult the installation manual for the most up to date installation information.

W415-4143 / C-0 / 04.09.24

# TALL VECTOR™ 62 DIRECT VENT LINEAR GAS APPLIANCE



## Specifications: See-through

Model	BTU	Width		Height		Depth		Viewing Area
		Actual	Framing	Actual	Framing	Actual	Framing	
TLV62N2	44,000	77 5/16	77 13/16	47 15/16	48 3/16	16 3/16	16 3/16	64 9/16 X 26 13/16
TLV62LN2								
TLV62P2	38,000	77 5/16	77 13/16	47 15/16	48 3/16	16 3/16	16 3/16	
TLV62LP2								

## Dimensions: See-through

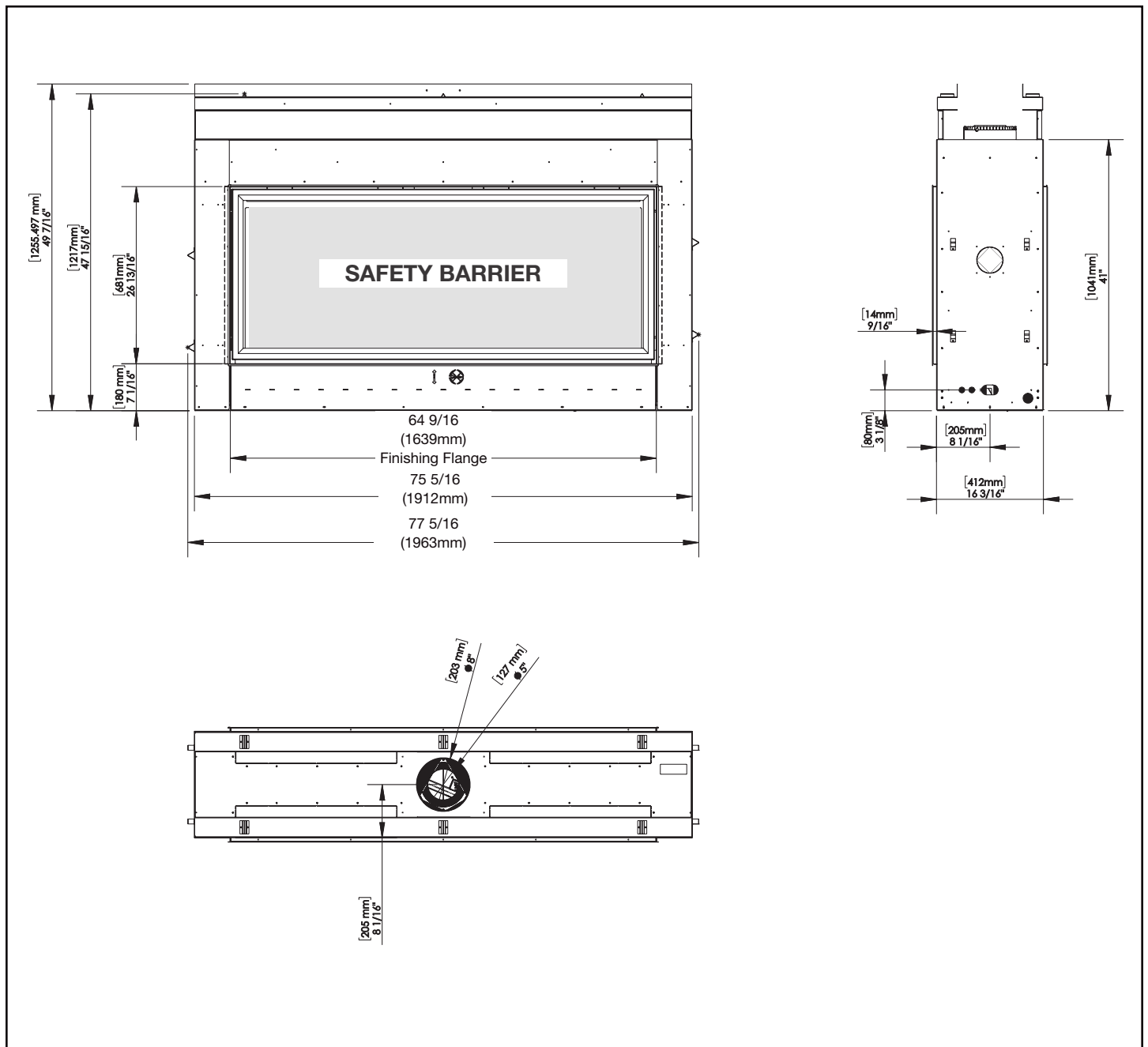

Product information provided is not complete and is subject to change without notice. Please consult the installation manual for the most up to date installation information.

W415-4143 / C-0 / 04.09.24

# TALL VECTOR™ 62 DIRECT VENT LINEAR GAS APPLIANCE



Product information provided is not complete and is subject to change without notice. Please consult the installation manual for the most up to date installation information.

## Finish Framing

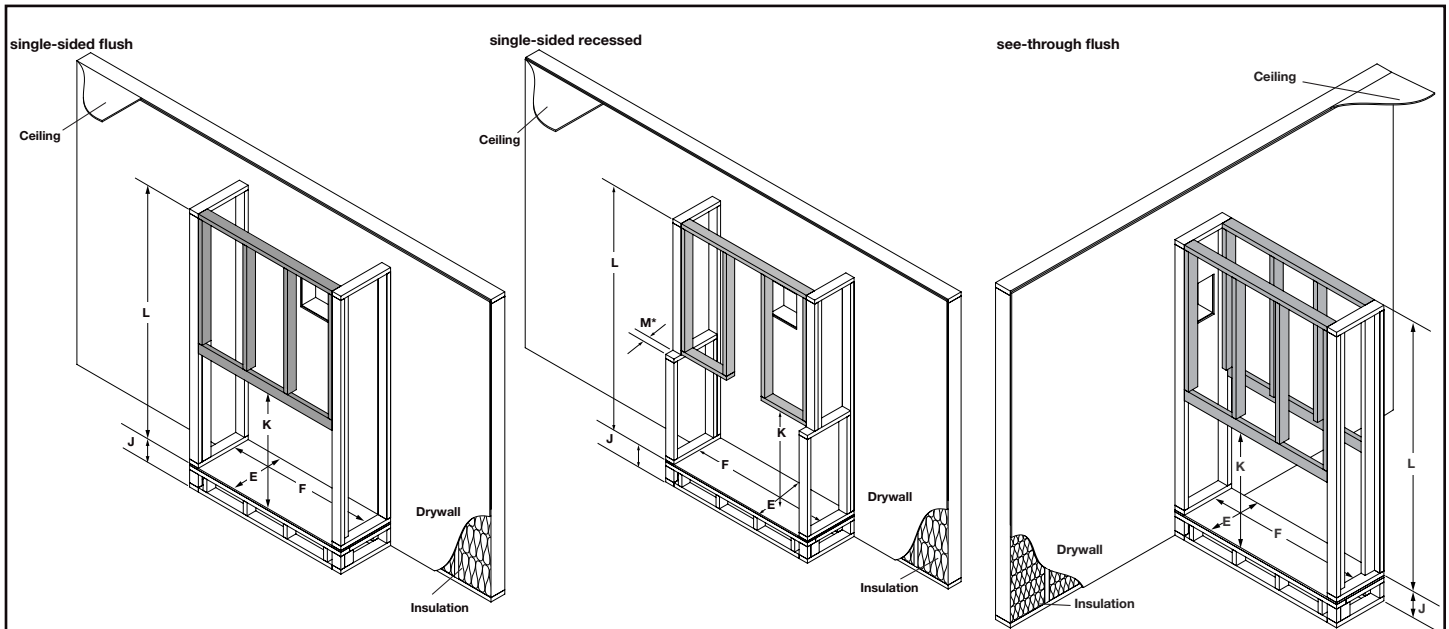

Ref.	TLV62 / TLV62L single-sided
K	48 3/16" (1224mm)
E	20 1/8" (511mm)
F	77 13/16" (1976mm)
J	Optional - Appliance does not need to be elevated above floor.
L	91" (2311mm)
M*	3" (76mm)

Ref.	TLV62_2 / TLV62L2 see-through
K	48 3/16" (1224mm)
E	16 3/16" (411mm)
F	77 13/16" (1976mm)
J	Optional - Appliance does not need to be elevated above floor.
L	91" (2311mm)

\*Can only be increased to 4" max by building a protrusion.

### note:

The TLV series requires a minimum enclosure/ceiling height, as illustrated (dimension L), measured from the bottom of the appliance. For temperature requirements, this area must be left unobstructed. Some venting configurations that require more vertical rise will require a larger enclosure to provide minimum vertical clearance between vent pipes and combustibles.

## Combustible Mantel Clearances

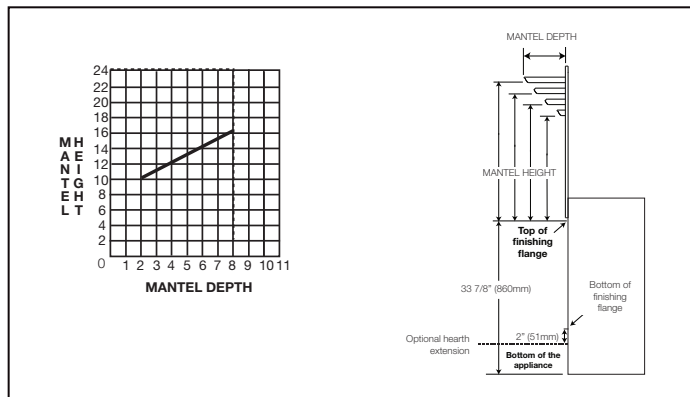

## Appliance Location

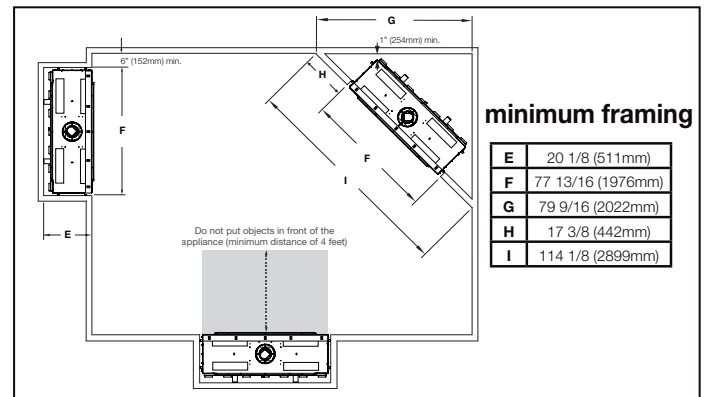

W415-4143 / C-0 / 04.09.24

# TALL VECTOR™ 74 DIRECT VENT LINEAR GAS APPLIANCE



## Specifications: Single-sided

Model	BTU	Width		Height		Depth		Viewing Area
		Actual	Framing	Actual	Framing	Actual	Framing	
TLV74N	48,000	89 5/16	89 13/16	47 15/16	48 3/16	19 7/8	20 1/8	76 9/16 X 26 13/16
TLV74LN								
TLV74P	41,500	89 5/16	89 13/16	47 15/16	48 3/16	19 7/8	20 1/8	
TLV74LP								

## Dimensions: Single-sided

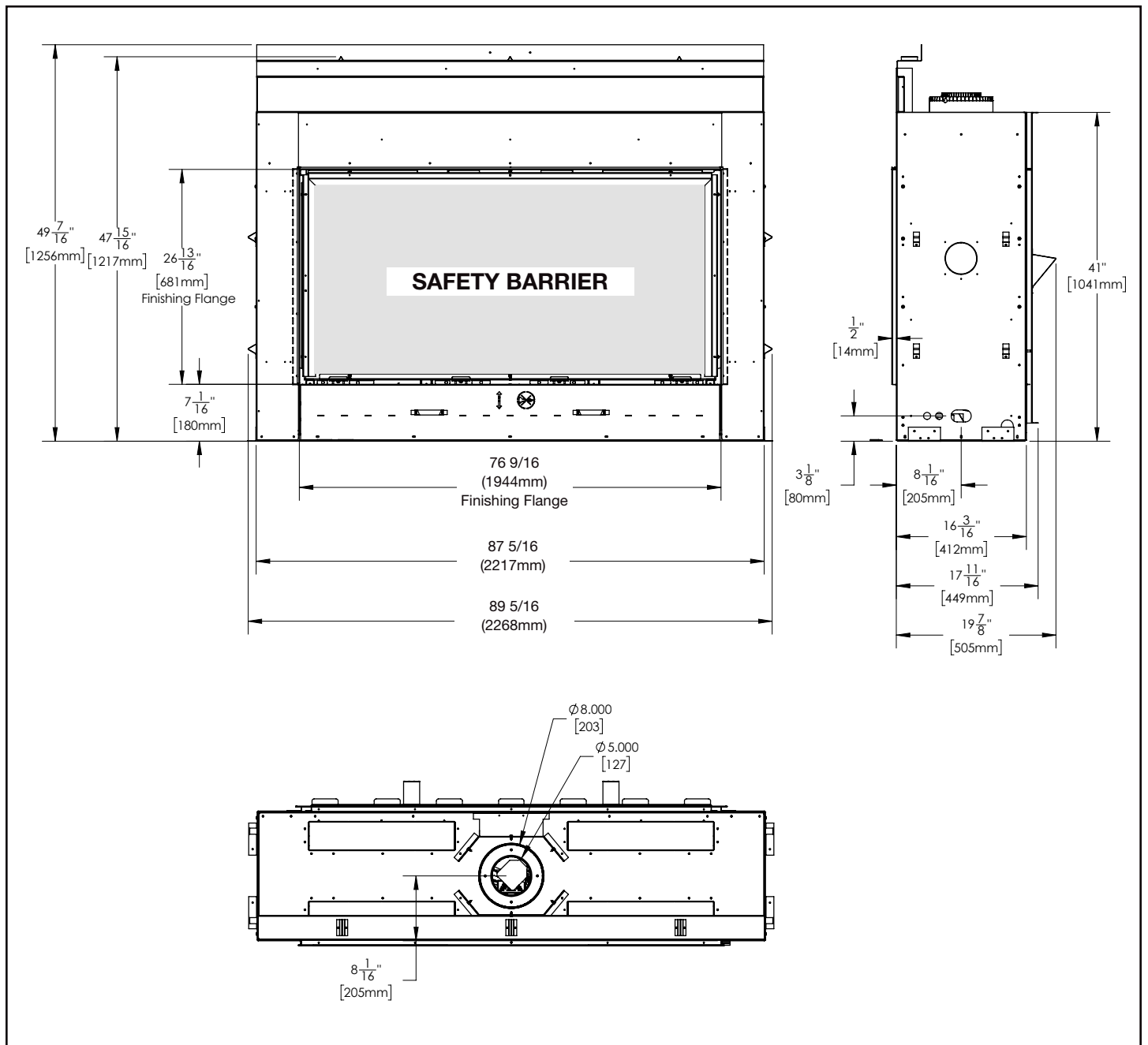

Product information provided is not complete and is subject to change without notice. Please consult the installation manual for the most up to date installation information.

W415-4144 / C-0 / 04.09.24

# TALL VECTOR™ 74 DIRECT VENT LINEAR GAS APPLIANCE



## Specifications: See-through

Model	BTU	Width		Height		Depth		Viewing Area
		Actual	Framing	Actual	Framing	Actual	Framing	
TLV74N2	48,000	89 5/16	89 13/16	47 15/16	48 3/16	16 3/16	16 3/16	76 9/16 X 26 13/16
TLV74LN2								
TLV74P2	41,500	89 5/16	89 13/16	47 15/16	48 3/16	16 3/16	16 3/16	
TLV74LP2								

## Dimensions: See-through

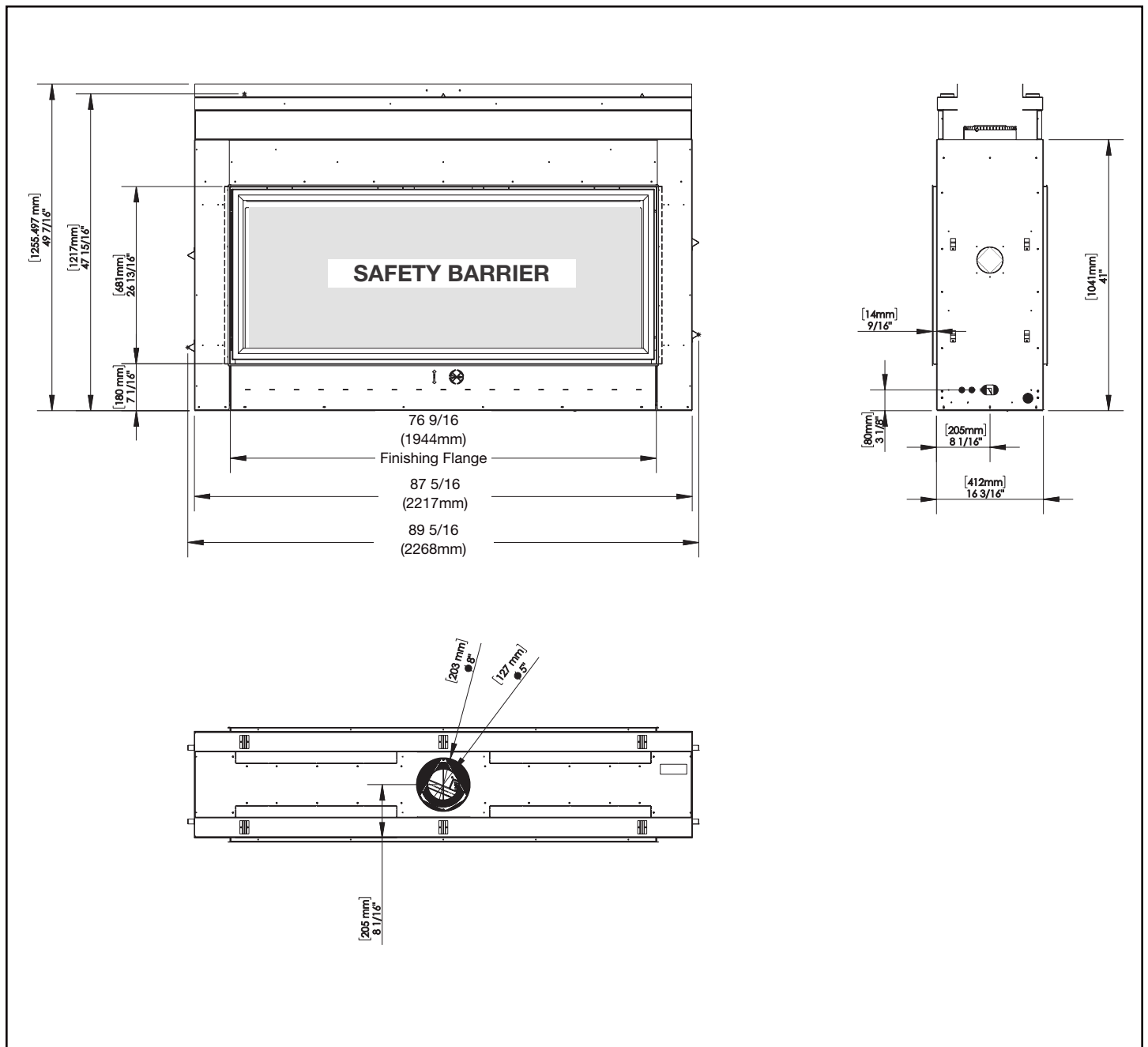

Product information provided is not complete and is subject to change without notice. Please consult the installation manual for the most up to date installation information.

W415-4144 / C-0 / 04.09.24

# TALL VECTOR™ 74 DIRECT VENT LINEAR GAS APPLIANCE



Product information provided is not complete and is subject to change without notice. Please consult the installation manual for the most up to date installation information.

## Finish Framing

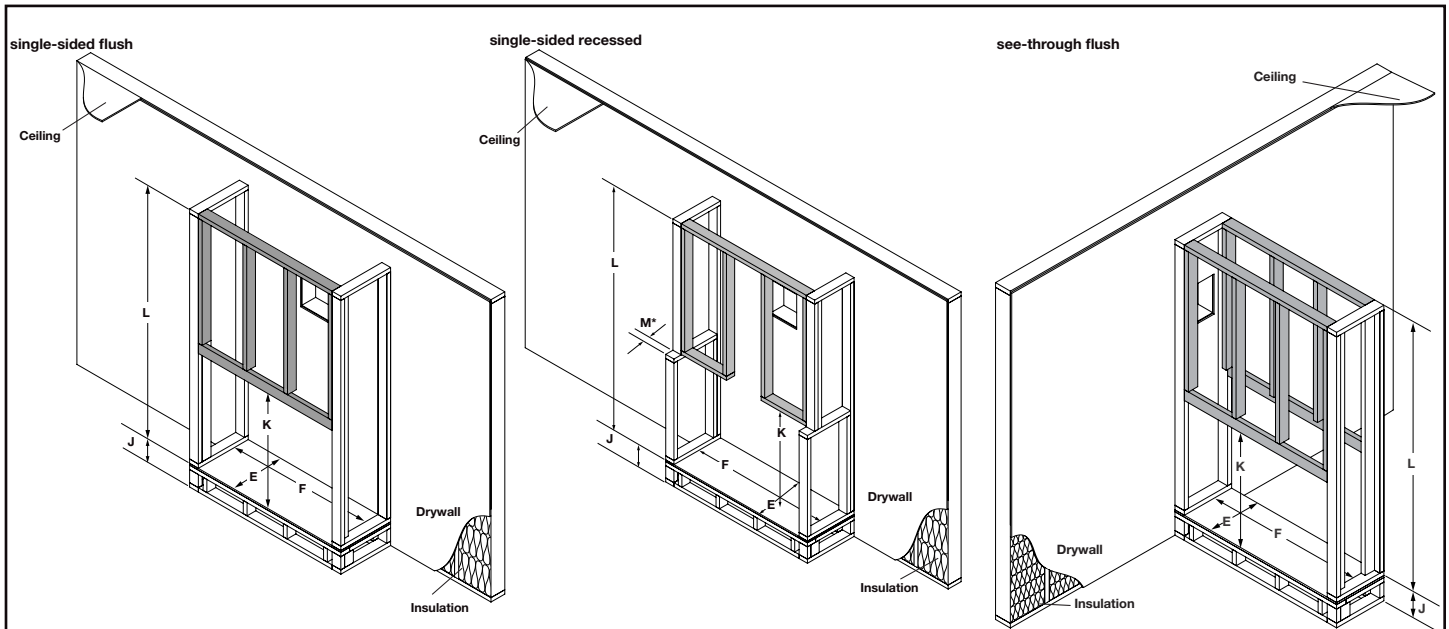

Ref.	TLV74 / TLV74L single-sided
K	48 3/16" (1224mm)
E	20 1/8" (511mm)
F	89 13/16" (2281mm)
J	Optional - Appliance does not need to be elevated above floor.
L	91" (2311mm)
M*	3" (76mm)

\*Can only be increased to 4" max by building a protrusion.

Ref.	TLV74_2 / TLV74L2 see-through
K	48 3/16" (1224mm)
E	16 3/16" (411mm)
F	89 13/16" (2281mm)
J	Optional - Appliance does not need to be elevated above floor.
L	91" (2311mm)

### note:

The TLV series requires a minimum enclosure/ceiling height, as illustrated (dimension L), measured from the bottom of the appliance. For temperature requirements, this area must be left unobstructed. Some venting configurations that require more vertical rise will require a larger enclosure to provide minimum vertical clearance between vent pipes and combustibles.

## Combustible Mantel Clearances

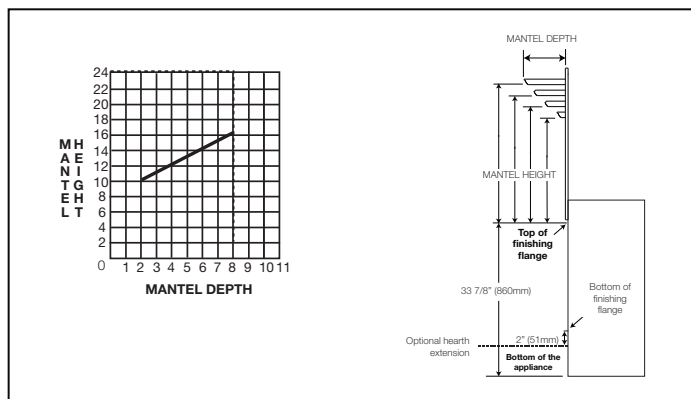

## Appliance Location

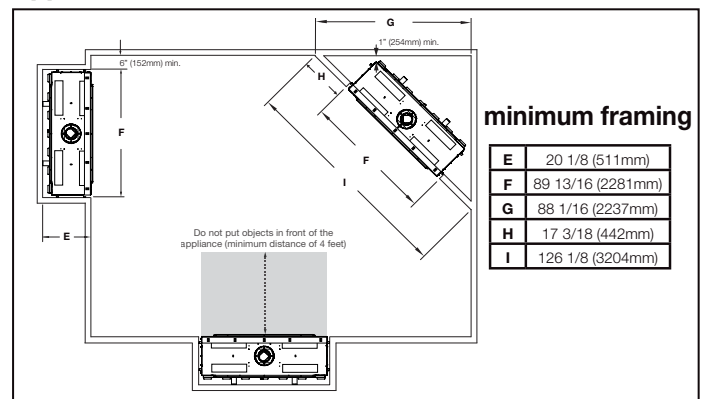

W415-4144 / C-0 / 04.09.24