

MONTIGO®

OUTDOOR

OUTDOOR / PROUDLY HANDCRAFTED IN NORTH AMERICA

H34VO

H38VO

HL38VO

H42VO

H38SVO

HL38SVO

PL42VO

PL60VO

R324STIO





OUTDOOR / HL38SVONE / EBONY FIRESTONES

A large outdoor fireplace with a thick, rustic stone surround is the focal point. The fire is burning brightly inside the glass-enclosed unit. In front of the fireplace is a low, round table made of a tree stump. To the left, there is a wooden-framed sofa with light blue cushions. The background shows a modern house with large windows and a wooden deck.

OUTDOOR



MONTIGO / MAHANA / PL42VONE / STAINLESS STEEL ENCLOSURE

A stainless steel outdoor fireplace is shown in the foreground. It has a rectangular glass front through which a blue and orange flame is visible. The fireplace is sitting on a wooden deck. In the background, there are outdoor chairs with light blue cushions.



REDEFINE YOUR OUTDOOR SPACE

THE WARMTH AND COMFORT OF YOUR LIVING ROOM NOW ON YOUR PATIO

Ventless design creates endless possibilities for placement in your outdoor space. All Montigo outdoor fireplaces are fabricated with high quality 304 stainless steel construction for extended outdoor life.

From traditional brick liners, all the way to multi-color LED lighting for the Mahana, all fireplaces in the Montigo Outdoor series have numerous options for customization.

DOOR

OUTDOOR HL38VONE SAGE FIREBEADS



OUTDOOR
OUTDOOR  SERIES

REDEFINE YOUR OUTDOOR SPACE

H34 H38 H42 TRADITIONAL

Standard

Traditional burner
and logset

Safety screen

Options

Various traditional liners

Mirror back panel

Drain pan

Wrought iron grate

HL38 CONTEMPORARY

Standard

Contemporary burner with
Ice fireglass

Safety screen

Options

Glass media

Drain pan

H34VO
H38VO
HL38VO
H42VO

SINGLE SIDED
VENTLESS
OUTDOOR





MONTIGO / DIVINE / HL38VON / SAGE FIREBEADS / SHOWN WITHOUT SCREEN



MONTIGO / DIVINE / H34VON / SHOWN WITHOUT SCREEN

OPTIONS &
FEATURES

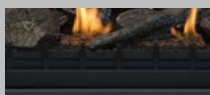

IRON GRATE
HWIG**



DRAIN PAN
ODSSP**

LINERS

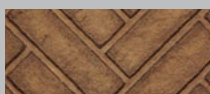

HERRING BONE
HBK**



COLONIAL
HBK**

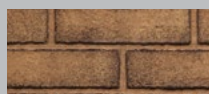

HERITAGE
HBK**

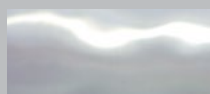

MIRROR
RPH**VOR

Features

Ventless design

Stainless steel
construction

OUTDOOR / PROUDLY HANDCRAFTED IN NORTH AMERICA

OUTDOOR
OUTDOOR  SERIES

CREATE YOUR OUTDOOR OASIS

H38SVO TRADITIONAL

Standard

Traditional burner
and logset

Manual Hi-Lo
flame control

Wrought iron grate

Safety screen

Options

Freestanding cool-touch
enclosure (HSI units only)

HL38SVO CONTEMPORARY

Standard

Contemporary burner
with Ice fireglass

Manual Hi-Lo
flame control

Safety screen

Options

Glass media

Freestanding cool-touch
enclosure (HSI units only)

H38SVO, HL38SVO

SEE THROUGH
VENTLESS
OUTDOOR



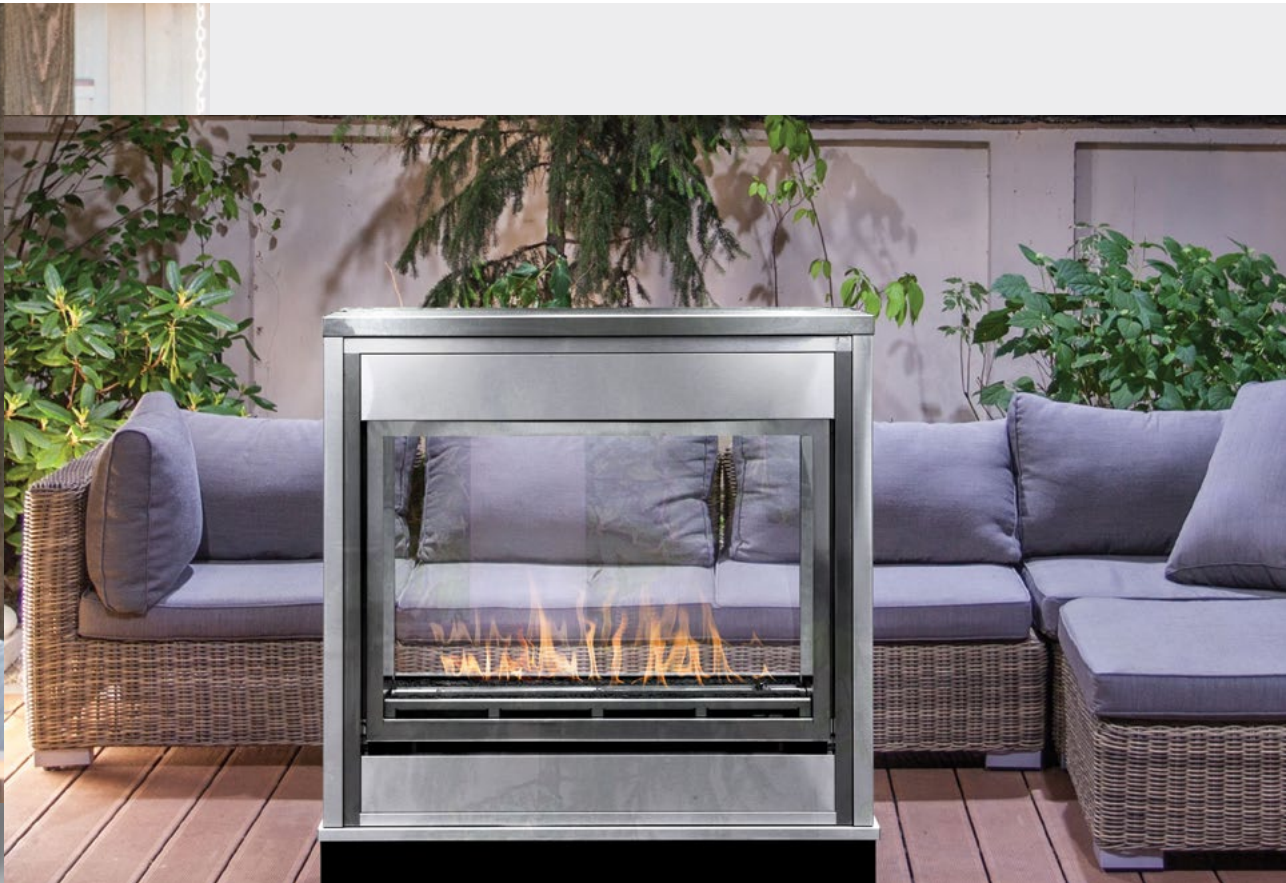

MONTIGO / DIVINE / H38SVON / TRADITIONAL LOGSET / SHOWN WITHOUT SCREEN



OPTIONS &
FEATURES



COOLTOUCH
ENCLOSURE¹
RTSCH38VO



Features

Ventless design

304 Stainless steel

Fans provide zone heating
up to 10'

OUTDOOR / PROUDLY HANDCRAFTED IN NORTH AMERICA

MAHANA
OUTDOOR  SERIES

A WARM BREEZE

MAHANA CONTEMPORARY

Standard

Concealed burner
with Quartz firebeads

Built in fan system

Safety screen

Options

LED backlighting

Stainless steel and
powdercoated enclosures

Enclosure pedestal

Enclosure cover

Speckled stones,
driftwood, glass media

Remote control on/off

PL42VO
PL60VO

VENTLESS
OUTDOOR



CARBON
RAL 9005

GRAPHITE
RAL 7015

DUNE
RAL 9002

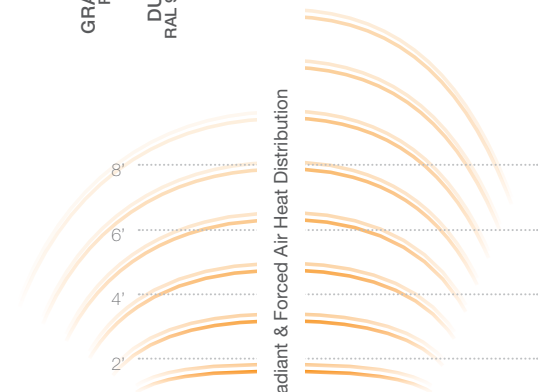

Radiant & Forced Air Heat Distribution

PL42VO

PL60VO



MONTIGO / MAHANA / PL60V0 / QUARTZ FIREBEADS /



OPTIONS & FEATURES



ENCLOSURES
PLVOBE**



ENCLOSURE
PEDESTAL
PL**VOBE-P



ENCLOSURE COVER
PL**CVR



LED BACKLIGHTING
PLVOBE**



REMOTE ON/OFF
RXM40VACVO



SPECKLED STONES
RR***SS

COPPER
HW1143

AMBER
HW1261

ICE
HW1157

GLACIER
HW1219B

PLATINUM
HW1144

ALABASTER
HW1260

OBSIDIAN
HW1113

ONYX
HW1259

MEDIA

FROST
HW1112

QUARTZ
HW1106

EBONY
HW1091

DRIFTWOOD
LGS***

Unit Specifications

ICON LEGEND

AVAILABLE

+

NOT AVAILABLE

-

DEDICATED

◊

STANDARD

°

| | BTU NATURAL GAS | BTU LIQUID PROPANE | CLEARANCE TOP | CLEARANCE SIDES | CLEARANCE BACK | CLEARANCE FLOOR | STANDARD MEDIA | FRONT GLASS TYPE | POWERVENT | REMOTE CONTROL | FANS | UPLIGHTING | DOWNLIGHTING |
|-----------|-----------------|--------------------|---------------|-----------------|----------------|-----------------|----------------|------------------|-----------|----------------|------|------------|--------------|
| H34VO** | 26,000 | 26,000 | 9 | 1† | 1† | 0 | TRADITIONAL | HIGH TEMPERATURE | - | - | - | - | - |
| H38VO** | 34,000 | 34,000 | 9 | 1† | 1† | 0 | TRADITIONAL | HIGH TEMPERATURE | - | - | - | - | - |
| HL38VO** | 34,000 | 34,000 | 9 | 1† | 1† | 0 | HW1157 | HIGH TEMPERATURE | - | - | - | - | - |
| H38SVO** | 34,000 | 34,000 | 36 | 12 | N/A | 0 | TRADITIONAL | HIGH TEMPERATURE | - | - | - | - | - |
| HL38SVO** | 34,000 | 34,000 | 36 | 12 | N/A | 0 | HW1157 | HIGH TEMPERATURE | - | - | - | - | - |
| H42VO** | 40,000 | 40,000 | 9 | 1† | 1† | 0 | TRADITIONAL | HIGH TEMPERATURE | - | - | - | - | - |
| PL42VO* | 28,000 | 28,000 | 0 | 1 | 0 | 0 | HW1106 | HIGH TEMPERATURE | - | - | ◊ | + | - |
| PL60VO* | 47,000 | 47,000 | 0 | 1 | 0 | 0 | HW1106 | HIGH TEMPERATURE | - | - | ◊ | + | - |

†Clearance to insulation jacket is 0"

DIVINE OUTDOOR FRAMING

| | A | B | C | D | E | F | G | H |
|-------|-----|-----|------|---|-----|-----|---|-----|
| H34VO | 38¾ | 35⅝ | 20¼† | * | 61⅞ | 35⅝ | 0 | 43⅝ |
| H38VO | 42½ | 39¼ | 21⅝† | * | 65⅞ | 39¼ | 0 | 49⅞ |
| H42VO | 46½ | 43½ | 22⅝† | * | 72¼ | 43½ | 0 | 51⅞ |

DIVINE OUTDOOR ST FRAMING

| | A | B | C | D |
|--------|----|----|-----|---|
| H38SVO | 38 | 41 | 23⅞ | * |

MAHANA FRAMING AND ENCLOSURE

| | A | B | C | D | E | F | G | H | I | J |
|--------|-----|----|-----|---|-----|----|---|-----|-----|-----|
| PL42VO | 27¼ | 42 | 11⅞ | * | 62⅞ | 42 | 0 | 48⅞ | 51⅞ | 34⅞ |
| PL60VO | 27¼ | 66 | 11⅞ | * | 87 | 66 | 0 | 65½ | 76⅞ | 34⅞ |

MAHANA ENCLOSURE

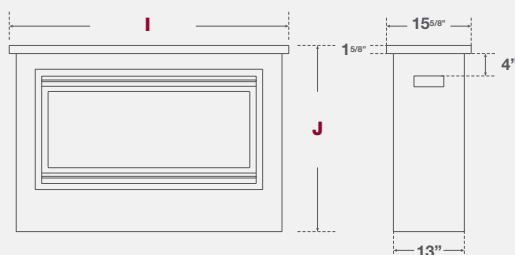

DIVINE OUTDOOR ST ENCLOSURE

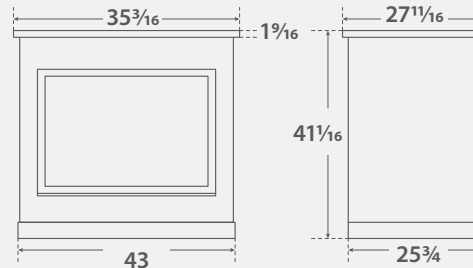

See instruction manual for detailed instructions

Be sure to plan a drain system for both in the wall and standalone installations.

*Check local codes and manual for minimum distance from grade to unit.

†Dimension is to back wall or back studs

1976: The Days Before Gas Fireplaces

In 1976, Montigo president and founder, Dan Binzer, started installing zero-clearance wood burning fireplaces for local builders in Vancouver, BC. Over the years, demand grew for a gas alternative, and Dan engineered and manufactured the first ever sandpan logset. The logset was installed in a zero-clearance wood burning fireplaces shell, resulting in one of the first zero-clearance gas fireplaces on the market.

1985: Gas Fireplace Manufacturing Begins

Demand for gas grew rapidly, especially among multi-unit developments so Dan Binzer started a company called Canadian Heating that would offer full service design, engineering and manufacturing for gas fireplaces. Under the Montigo brand, Canadian Heating began manufacturing and selling a wide selection of zero-clearance gas fireplaces throughout Canada and in 1985 development began for the latest and greatest in gas fireplace technology – direct venting.

1994: Manufacturing Excellence is Achieved

Development and advancement of the gas fireplace continued over the years with continual developments to improve the efficiency of the fireplaces and perfected manufacturing processes to deliver an optimum fireplace each and every time – even for completely custom units.

Present: Leading the Way with Modern Fireplace Design

As one of the first to bring a linear designed fireplace to market, Montigo now offers the largest selection of linear fireplaces demanded by designers, architects and homeowners wanting to create a modern and contemporary space and homeowners wanting to create a modern and contemporary space.

WARNING

Some materials used in the manufacturing process of this product can expose you to Benzene which is known in the State of California to cause cancer and birth defects or other reproductive harm. For more information go to www.P65warnings.ca.gov

for more inspiration go to
www.montigo.com

MONTIGO[®]
the art of **fireplaces**



Our Guarantee

Montigo[®] stands behind the craftsmanship and durability of our products by providing a 15 year warranty on the burner and firebox in all our residential fireplaces.



Printed in USA

XB2210